



Combination Air Valve for Sewage

AS11/1

DN80 - DN200

PN 10/16

Air Relief Valve will ensure the correct operation of pipeline networks allowing the release of the air pockets during working conditions, the evacuation and the entrance of large volumes of air in case of filling and draining operations.

Technical Details

Maximum Working Pressure PFA:

16 bar / PN16

Working temperature:

Maximum +90°C

Flange Type:

EN 1092-2 PN10 & PN16

(other flange types available on request)

Coating:

300 µm FBE coating, external and internal - RAL5015

Installation:

Assembly the vertical position only

Application:

Installation for water and other liquids carrying solid particles such as sewage and effluent

Design features

- Actuated only by the process fluid for fully automatic function
- Single chamber double orifice triple function air and vacuum automatic release valve.
- Designed to operate with liquids carrying solid particles such as sewage and effluent.
- Complete separation of the liquid from the sealing mechanism provides optimum work conditions
- All inner metal parts made of stainless steel 316.



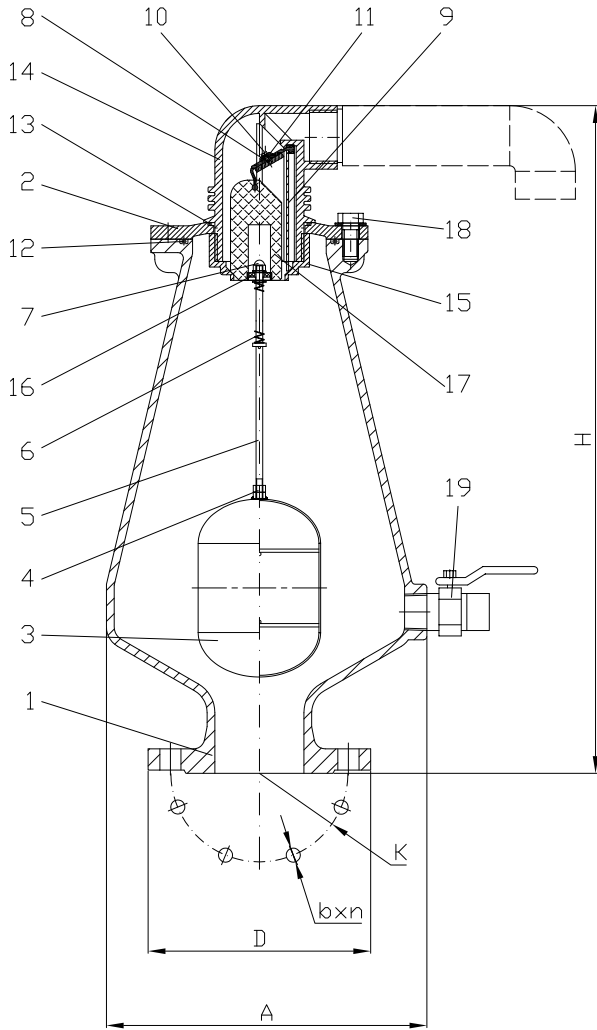

No	Part Name	Material
1	Body	Ductile Iron EN-GJS-500-7
2	Bonnet	Ductile Iron EN-GJS-500-7
3	Float	Stainless Steel X5CrNiMo17-12-2/1.4401/316
4	Nut	Stainless Steel X5CrNiMo17-12-2/1.4401/316
5	Spindle	Stainless Steel X5CrNiMo17-12-2/1.4401/316
6	Spring	Stainless Steel X5CrNiMo17-12-2/1.4401/316
7	Crown Nut	Stainless Steel X5CrNiMo17-12-2/1.4401/316
8	Disc	NBR+SS316+Nylon
9	Plate	Stainless Steel X5CrNiMo17-12-2/1.4401/316
10	Bolt	Stainless Steel X5CrNiMo17-12-2/1.4401/316
11	Washer	Stainless Steel X5CrNiMo17-12-2/1.4401/316
12	Gasket	Elastomer NBR
13	O-ring Seal	Elastomer NBR
14	Cover	Plastic Nylon
15	Plastic Base	Plastic Nylon
16	Stoper	Polythene PE
17	Guide Block	Polythene PE
18	Bolts/Washers	Stainless Steel X5CrNiMo17-12-2/1.4401/316
19	Ball Valve	Stainless Steel X5CrNiMo17-12-2/1.4401/316

Dimension (mm & kg)

Group	DN	80	100	150	200
AS11/1	PN16	BA0508	BA0510	BA0515	AE1024
	PN10				AE1033
A		275	275	275	275
H		601	601	601	601
∅S		94	110	150	200
K		160	180	240	295
b x n PN16 / PN10		19x8	19x8	23x8	23x12 / 23x8
D		200	220	285	340
Weight kg		25	26	28	31